

e-Cruise

Installation instructions for
Toyota Hilux Facelift all diesel models Production 2009 >
Execpt models before 2011 without audio switch in the steering wheel - Use partno. 1530351



Before installation.

To make the installation easier, the complete installation instruction should be read through, before the installation is started.

This installation instruction, contains information, how to install the E-Cruise, which is not a Do-It-Yourself job.

Modern cars are equipped with electronic, which can be costly damaged by inappropriate treatment.

Lindgaard · Pedersen A/S can not be held responsible, for any error caused by wrong installation.

Check that all the parts are included in the kit.

1 pcs. Unit.
 1 pcs. 14-p connector.
 1 pcs. 12-p connector.
 1 pcs. Clutch switch.
 1 pcs. Screws for the switch.
 5 pcs. Cableties.
 1 pcs. Installation guide.
 1 pcs. Owners manual.

Genuine parts required is not available from EL-PAS.

1 pcs. 84632-34011 Switch
 1 pcs. 84633-48020 Wire.
 1 pcs. 45186-58020-C0 Cover for Model 2009 - 2011
 1 pcs. 45186-33070-B0 Cover for Model 2011 >

Some good advice.

- Always disconnect the negativ cable from the battery, before installing.
- Always use the enclosed installation instruction for installing the E-Cruise.
- The rev. number on the unitlabel and the installation guide must be the same.
- Be aware that eg. radio code might has to be typed in.
- Find a location to install the unit and control switch.
- If any wire(s) left, then cut off and insulate.
- Only use multimeter to measure.
- Always drive the car for a complete test, before assemble the car.
- Flying lead(s) must be soldered.
- All wire connections are viewed from wire side.

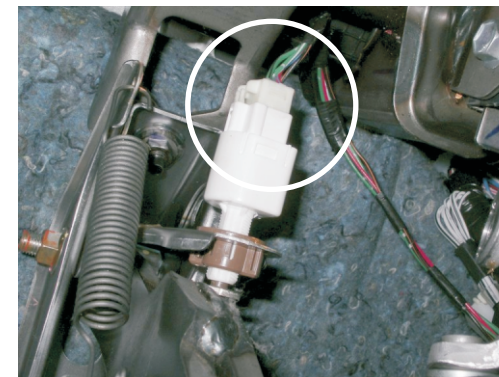
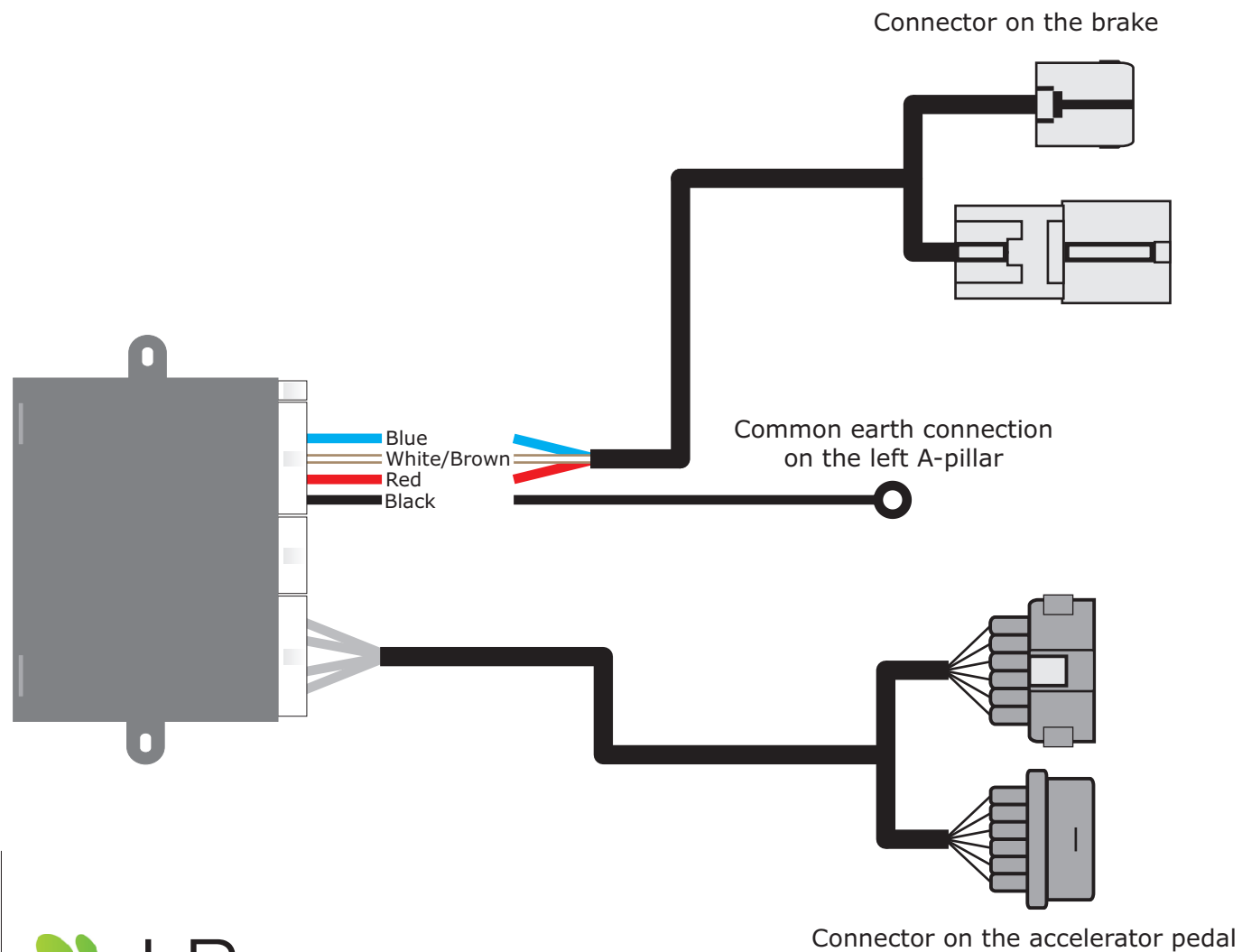

Use this solution if the vehicle is not equipped with a original clutch switch

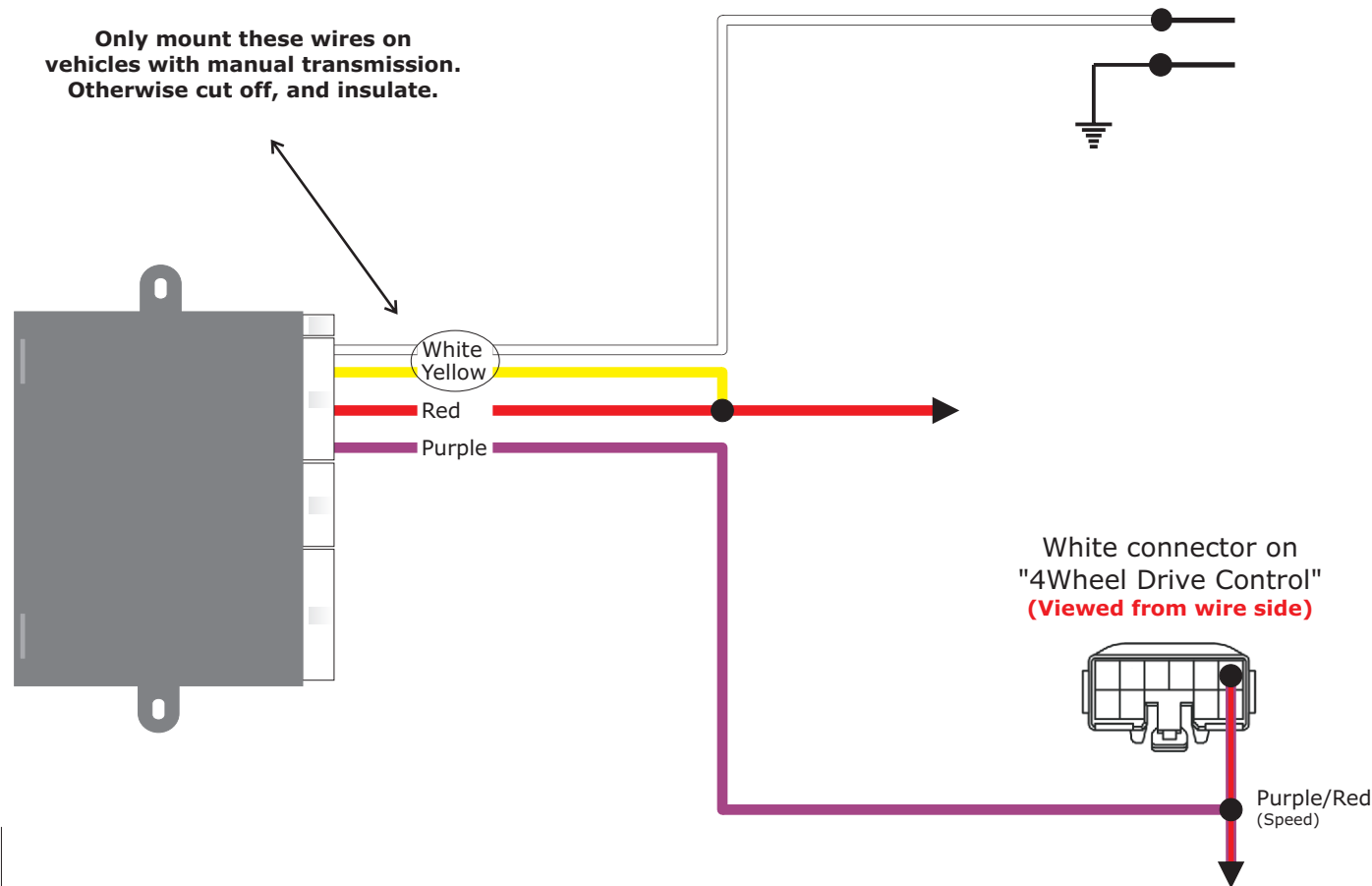

The Pedal stop is measured and replaced by the enclosed clutch switch. The clutch switch must be placed on the same level as the pedal stop



Use this solution if the vehicle is equipped with a original clutch switch

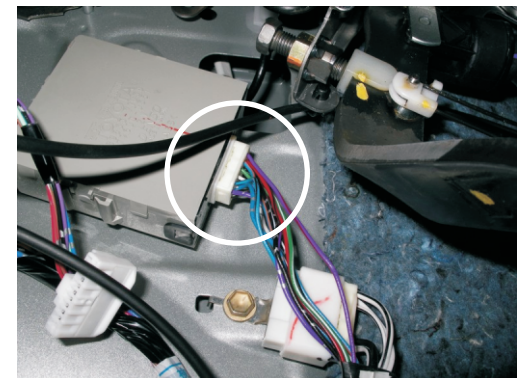
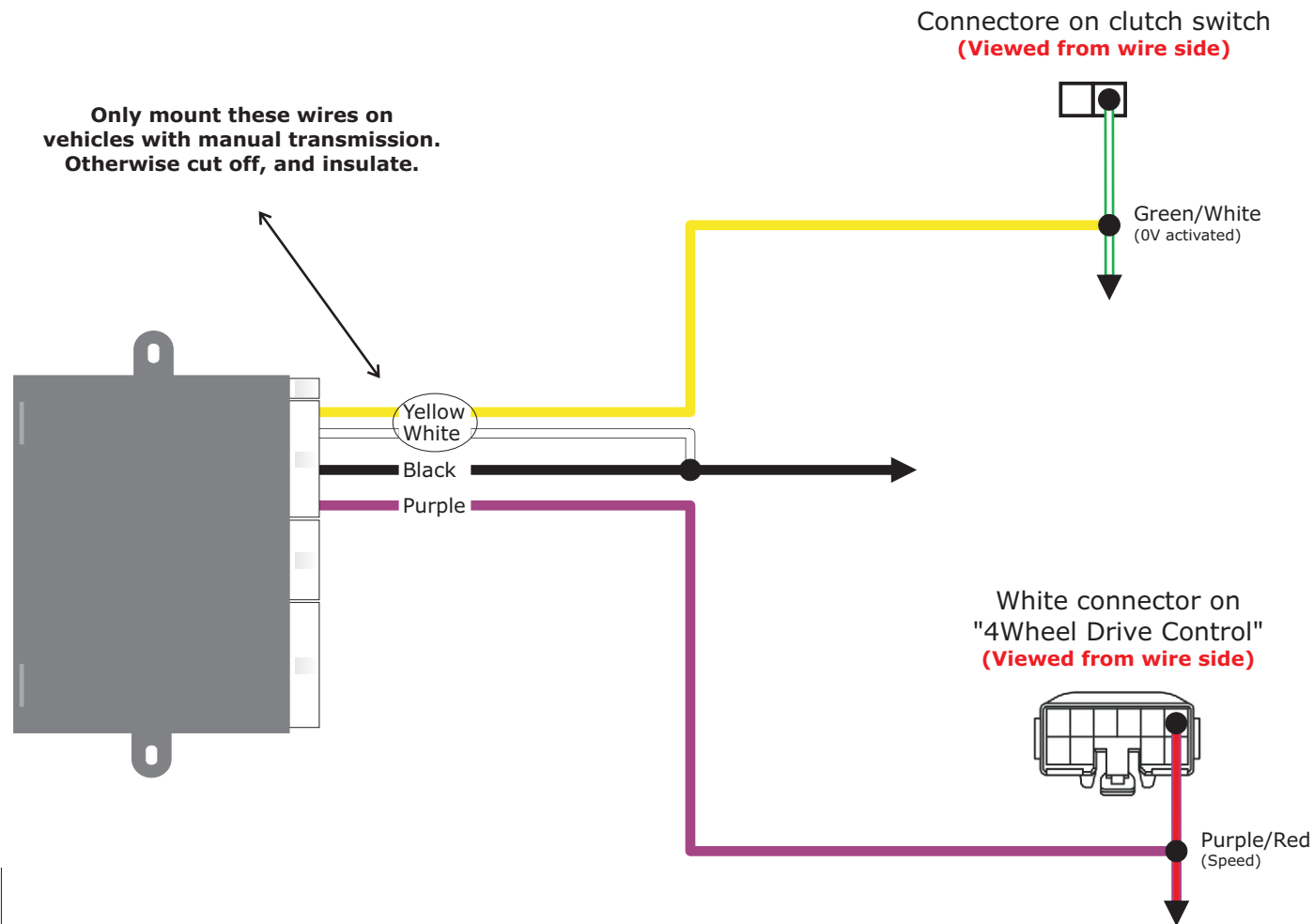

Disconnect the airbag in the manner described by TOYOTA.

Mount the connector for the lever in place, and install the lever in the steering wheel with the two enclosed screws. Mount the connector from the lever, in the 4-pol connector for the clock spring.

Reinstall the steering wheel and reconnect the airbag.

Mount the new cover around the lever. (Alternatively, use the drill template).

45186-58020-C0 **Cover (Model 2009 - 2011)**

45186-33070-B0 **Cover (Model 2011 >)**

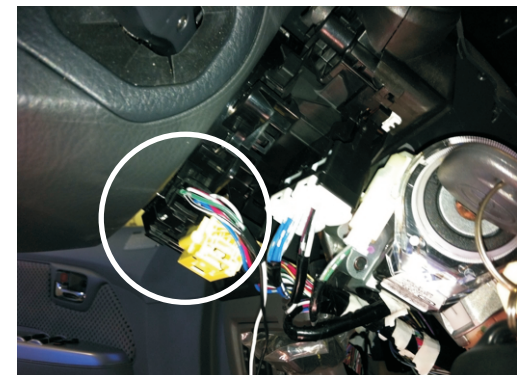
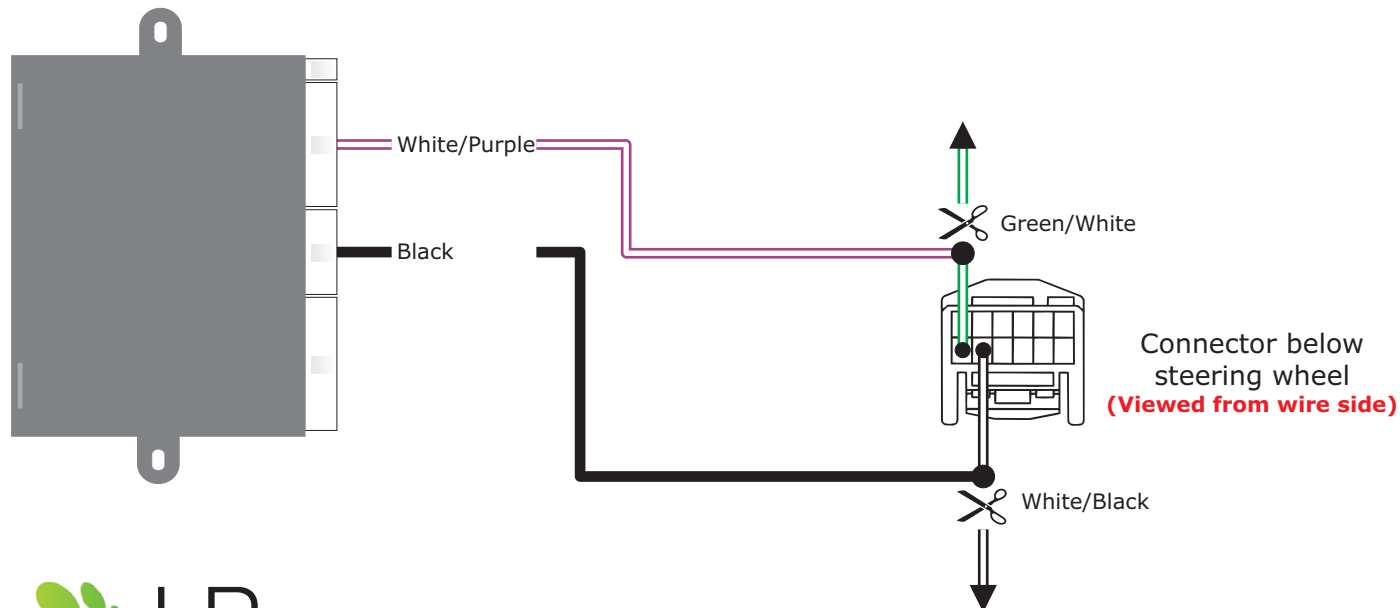

Cut the Green/White and White/Black, and solder the Black and White/Purple wires from the E-Cruise as showed on the picture.

If no wires is present in the connector, insert the Black and White/Purple in the connector, in same position.

1531580 Rev. 1.5

Trouble shooting guide.

Enable Diagnostic mode:



Put ignition on the vehicle

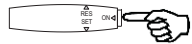

Within 2 seconds, press and hold the ON function



Wait until test LED lights up in RED color



Release ON function



Within 5 seconds

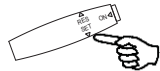

Press and hold SET function



The test LED lights up in ORANGE color



Release SET function



Within 5 seconds



Press RES function



The test LED will flash in all 3 colors, provided that no inputs are activated.
Otherwise the test LED will light up red.

Reaction to the individual tests, requires that the function is active

Test 1 - Brake function. Activate RES briefly. Test LED will flash orange 1 time.

CANbus installation: (No wires mounted on the brake connector).

1. Test LED lights up Red, and changes to green when pedal is depressed.

Analog installation: (Wires mounted on the brake connector).

1. If both brake wires are installed correctly, the test LED will light up green.
2. Hot side of brake is defective = test LED lights up red.
3. Cold side of brake is defective = test LED lights up orange.
4. Both sides of brake defective = test LED flashes all 3 colors.
5. When brake pedal is depressed, the test LED lights up orange.

Test 2 - Clutch function. Activate RES briefly. Test LED will flash orange 2 times.

CANbus installation: (No wires mounted on the clutch connector).

1. Test LED lights up Red, and changes to green when pedal is depressed.

Analog installation: (Wires mounted on the clutch connector).

1. If clutch wires are installed correctly, the test LED lights up green.
2. If clutch is defective, the test LED lights up red.
3. When clutch pedal is depressed, the test LED lights up red.

Test 3 - Accelerator pedal function (engine off). Activate RES briefly. Test LED will flash orange 3 times.

1. The test LED will slowly flash red/green.
2. Depressing the accelerator pedal will increase the freq. of the flashing.

Test 4 - VSS function (engine running). Activate RES briefly. Test LED will flash orange 4 times.

CANbus installation: (Purple wire is not connected).

1. The test LED will flash green if correct ID is received.

Analog installation: (Purple wire is connected).

1. The test LED will flash green when vehicle is moved.

Test 5 - TACHO function (engine running). Activate RES briefly. Test LED will flash orange 5 times.

CANbus installation: (Purple wire is not connected).

1. The test LED will flash green if correct ID is received.

Analog installation: (Purple wire is connected).

1. The test LED will flash green when RPM is raised.

Test 6 - Setup to Automatic gear. Activate RES briefly. Test LED will flash orange 6 times.

(This point should ONLY be performed if it is described on the front page with red text).

1. Activate and hold down the brake pedal.
2. Activate SET briefly = test LED lights up red.
3. Activate SET briefly again = test LED lights up orange. E-Cruise is set for automat gear.
If this function is activated by mistake. The test procedure must be entered from start.

Setup to Manual gear.

1. Activate and hold down the brake pedal.
2. Activate SET briefly = test LED lights up green.
3. Activate SET briefly again = test LED lights up orange. E-Cruise is set for manual gear.